

YOUR NUMBERS MATTER



MOD. CS-7

Standard straight numbering head, curved base, 7 wheels, 3/16" (engraving code 0002).

- 1S Actuating pawl pin.
- 2S Base locating spring.
- 3S Gib holding screw.
- 4S Bridge plate screw.
- 5S Tube shaft set screw.
- 6S Tube shaft set screw for spring return.
- 7S Swing screw.
- 8S Base locating screw.
- 9S Swing retaining spacer.
- 10S E-ring.
- 11S Drop wheel central shaft.
- 12S Retaining pawl spring.
- 13S Actuating pawl spring.
- 14S Central shaft.
- 15S Gib.
- 16S Gib locking screw.
- 17S Return spring.
- 18S Retaining pawl pin.
- 19S Tens retaining pawl.
- 20S Unit retaining pawl.
- 21S Swing.
- 22S Unit wheel.
- 23S Tens wheel.
- 24S Drop tens wheel.
- 25S Spacer wheel.
- 26S Curved base frame.
- 27S Spring return operating arm.
- 28S Actuating pawl.
- 29S Operating arm.
- 30S Bridge plate engraved.
- 31S Gib spring.

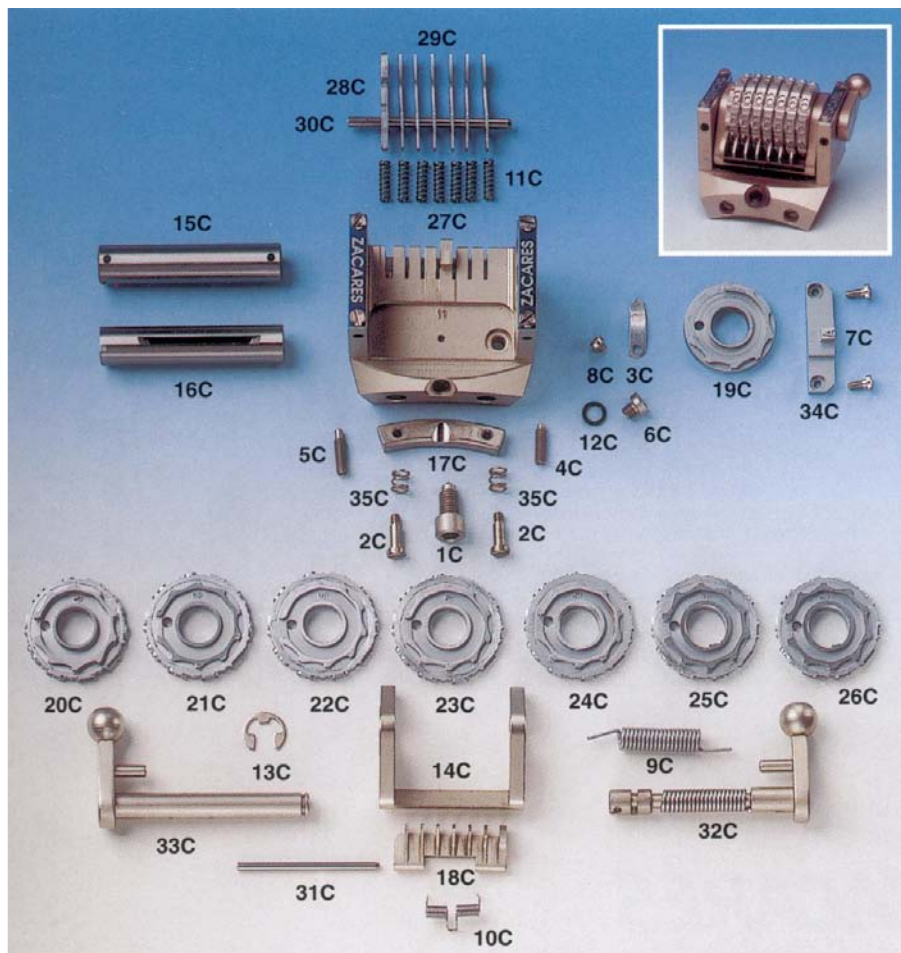
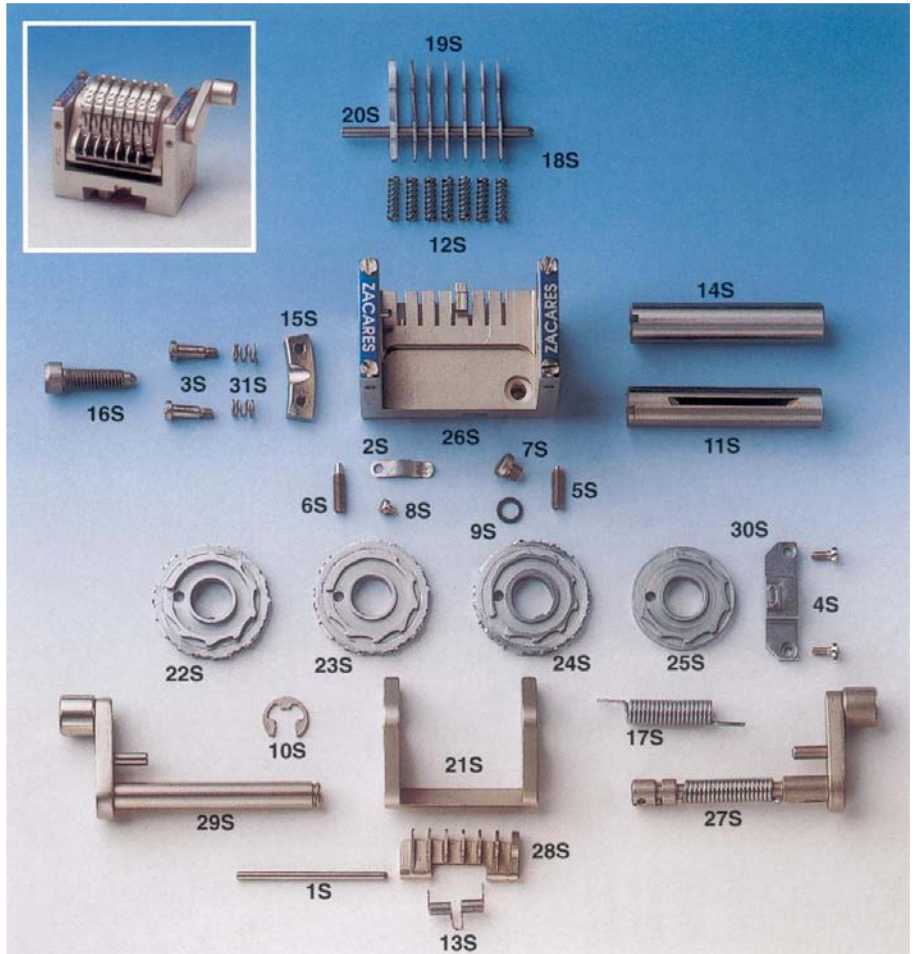

MOD. CC-7

Standard convex numbering head, curved base, 7 wheels, 3/16" (engraving code 0002).

- 1C Gib locking screw.
- 2C Gib holding screw.
- 3C Base locating spring.
- 4C Tube shaft set screw.
- 5C Tube shaft set screw for spring return.
- 6C Swing screw.
- 7C Bridge plate screw.
- 8C Base locating screw.
- 9C Return spring.
- 10C Actuating pawl spring.
- 11C Retaining pawl spring.
- 12C Swing retaining spacer.
- 13C E-ring.
- 14C Swing.
- 15C Central shaft.
- 16C Drop wheel central shaft.
- 17C Gib.
- 18C Actuating pawl.
- 19C Spacer wheel.
- 20C Unit wheel.
- 21C Tens wheel.
- 22C Hundreds wheel.
- 23C Thousands wheel.
- 24C Ten thousands drop wheel.
- 25C Hundred thousands drop wheel.
- 26C Millions drop wheel.
- 27C Curved base frame.
- 28C Unit retaining pawl.
- 29C Tens retaining pawl.
- 30C Retaining pawl pin.
- 31C Actuating pawl pin.
- 32C Spring return operating arm.
- 33C Operating arm.
- 34C Bridge plate engraved.
- 35C Gib spring.

SPECIAL DESIGNS



Special performance from 49 to 00, skip -1.



Arabian style numbering head.

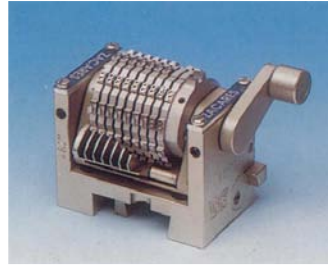

OCR-B1, straight box, with pre-inking and wheel-blockage functions.

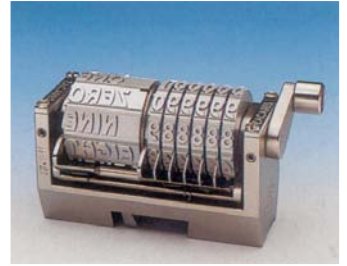

Special engraving with long text wheel for lottery applications.

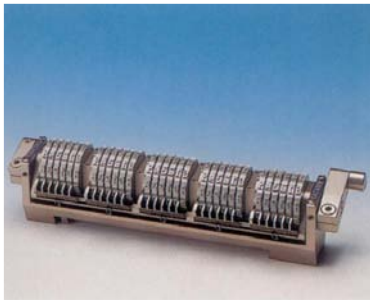

Special box, 5 automatic fields.



Special box, Code 39.

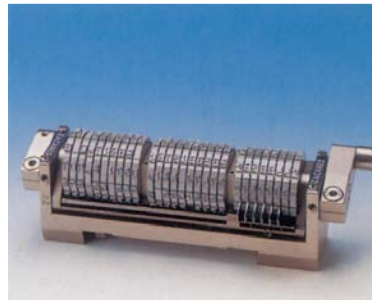

Special MICR box for cheques.



Manual numbering head for corrections.

MAINTENANCE

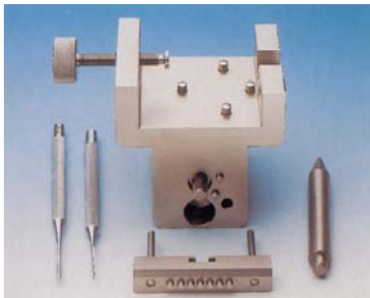

Mounting tool including ejector shaft, and punches for actuating pawl pin and retaining pawls pin.



Torque wrench.



Drop-to-drop oiler.



P-1 Oil, free of resins.



LENAG, special cleaner for numbering heads.



Ultrasonic device for cleaning numbering boxes.



Special ink for numbering.

RINGS



Heidelberg GTO.
Cod.: AN0049 (GTO 46)
Cod.: AN0051 (GTO 52)

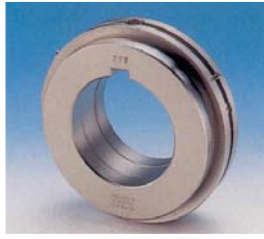

Heidelberg SM-52.
Cod.: AN0229



Heidelberg MO.
Cod.: AN0053



Sakurai - Oliver 58.
Cod.: AN0055



Hamada 700 CDN/E47N
Gestetner 353/470 NP.
Cod.: AN0012

FINGER CAMS



Ryobi 480 KNP/520/500 NP.
Cod.: DC0004



AB-Dick 8805 / Hamada 700 CDNP.
Cod.: DC0002

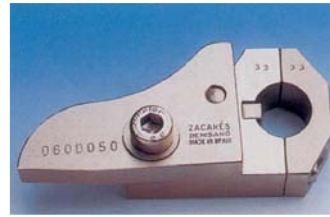

Sakurai - Oliver 52.
Cod.: DC0006



Adast 514.
Cod.: DC0025

CAMS



Heidelberg GTO 46/52. double-side.
Cod.: CC0004
Heidelberg MO, double-side. Cod.:
CC0003



Heidelberg SM-52
double-side.
Cod.: CC0011



Adast std. cam.
Cod.: EX0040 (22,263")
Cod.: EX0071 (24,74")



Praktika 00/01 LH std. cam.
Cod.: EX0021

PERFORATION ARMS



Heildeberg GTO 46.
Cod.: PE0002



Heildeberg GTO 52.
Cod.: PE0001

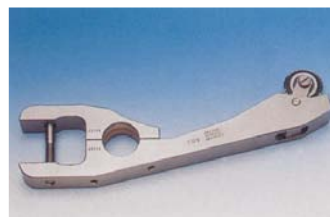

Special maximum-approaching-to-
numbering for GTO 46/52.
Cod.: PE0009



Heildeberg MO.
Cod.: PE0004

STRIKE-IN-BLOCKS



Standard straight 27,7 x 45,1 mm.



Standard convex 65 x 35 mm.



U-shaped 50 mm wide
strike-in-block.

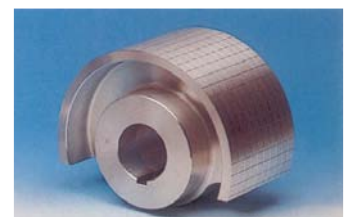

Solid 100 mm wide strike-in-block.

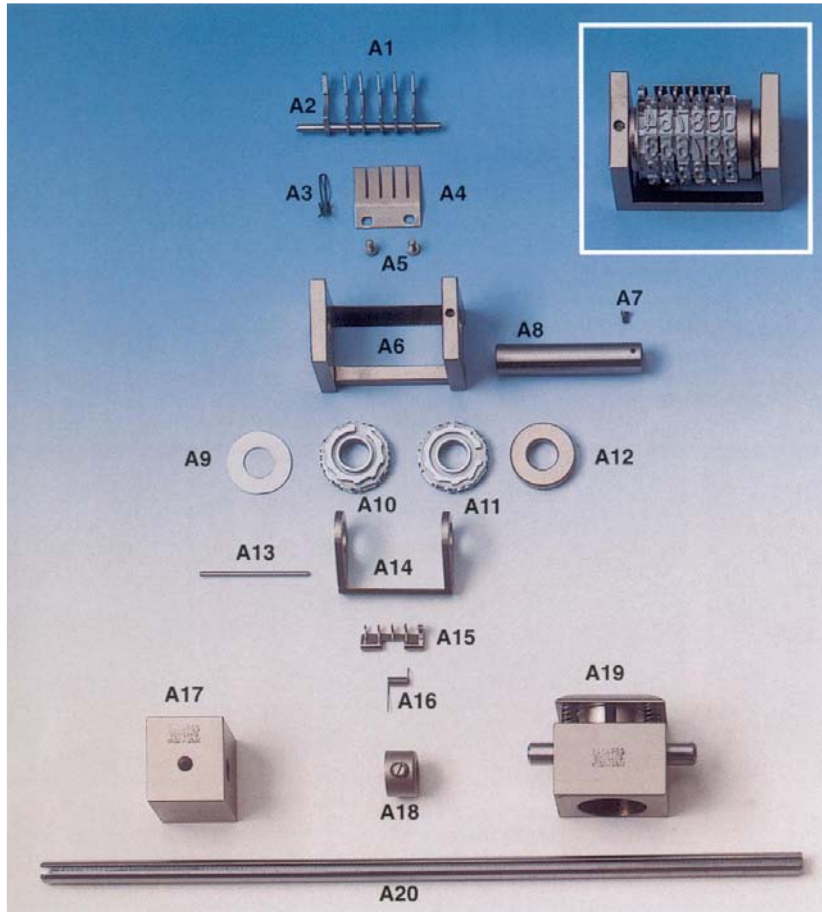

Standard centre-drive numbering boxl, 6 wheels, gothic 4,5 mm. (engraving code 0058).

- A1 Retaining pawls.
- A2 Retaining pawls pin.
- A3 Retaining pawls spring.
- A4 Retaining pawls plate.
- A5 Retaining pawls plate screws.
- A6 Frame.
- A7 Centre shaft screw.
- A8 Centre shaft.
- A9 Spacer.
- A10 Unit wheel.
- A11 Tens wheel.
- A12 Blank wheel.
- A13 Actuating pawl pin.
- A14 Swing.
- A15 Actuating pawl.
- A16 Actuating pawl spring.
- A17 Support block.
- A18 Locking ring.
- A19 Plunger.
- A20 Slotted rod.

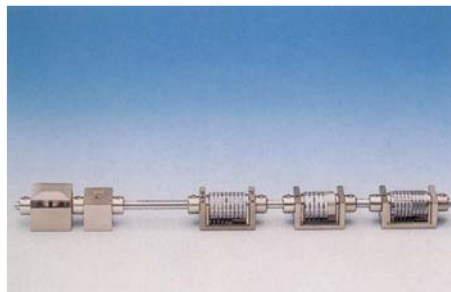

Slotted operating rod with plunger, collars, blocks and several boxes.

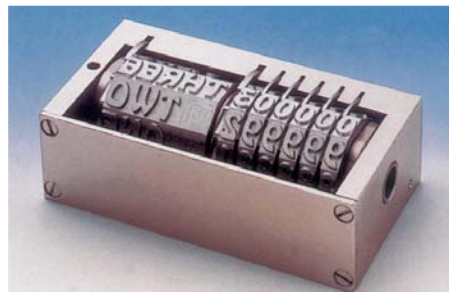

Special centre-drive head for lotteries.

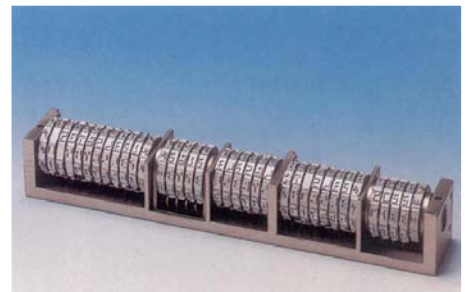

Centre-drive box for cheques, two automatic fields.

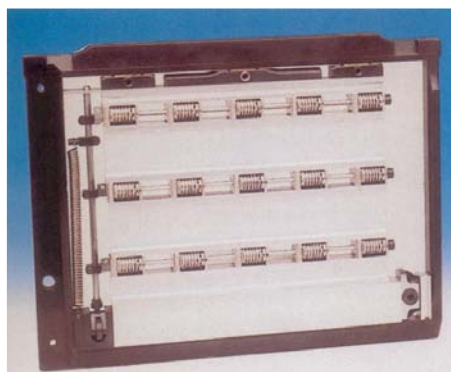

Master plunger Minerva-style chase.



Spring return exterior limit-stops chase.

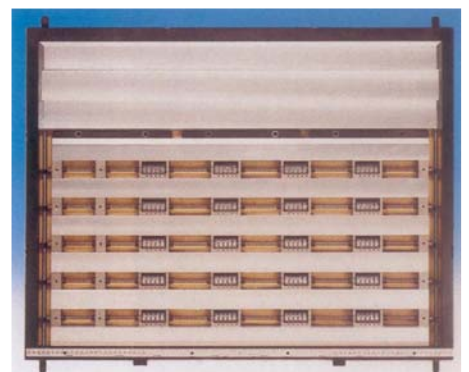

High security double interior and exterior limit-stops chase.

CODE	PRINTING SAMPLE	HEIGHT	PITCH
0001	0123456789	3.50	3.33
0002	0123456789	4.76	3.83
0003	0123456789	6.35	3.83
0030	0123456789	3.10	3.175
0042	0123456789	2.50	2.00
0053	0123456789	3.26	3.175
0058	0123456789	4.50	3.57
0075	0123456789	6.35	5.00
1008	0123456789	4.76	3.83
1038	0123456789	3.50	3.33
2089	0123456789	5.50	4.32
6070	· ۱۲۳۴۵۶۷۸۹	4.76	3.83

CODE	PRINTING SAMPLE	HEIGHT	PITCH
0103	0 ZRO 1 ONE 2 TWO 3 THR 4 FOR 5 FVE 6 SIX 7 SVN 8 EGT 9 NIN	5.25	10.00
2095	0 1 2 3 4 5 6 7 8 9 Z0 on tw th fo fv SX Sn et nn	5.57	4.00
9017	0123456789	4.00	3.175
9020	0123456789	3.00	2.54

CODE	PRINTING SAMPLE	HEIGHT
3004	0123456789-./*	OCR B1
3037	0123456789	FARRINGTON 7B
4006	0123456789 [Barcode]	CMC-7
4019	0 1 2 3 4 5 6 7 8 9 [Barcode]	E13B
5600	[Barcode] * 0 1 2 3 4 5 6 7 8 9 *	CODE 39

SPECIAL INK FOR NUMBERING

Zacarés has developed new inks specially formulated for letterpress numbering applications (numbering boxes).



The first family is letterpress classic inks, good for all kinds of applications of numbering and machines. Fresh and with high intensity ink, especially designed for numbering machines. These inks have a high image definition and transference, keeping the ink stable and fresh on the rollers during long time, and drying quickly on the paper. It can be supplied in black or red colours as standard, but also in any other colour required.

The second type of inks are the magnetic (MICR) inks, for magnetic codes numbering applications. It is specially designed to number magnetic engraving fonts (MICR): CMC and E13B. Quality ink for security documents.

Both families with the incentive of a good ink and a high performance.



Sales and Services by:
India
VINSAK India Pvt. Ltd.
email: info@vinsak.com
Call: +91 (0)124 - 414 3827/8

SPACE PREVENT US FROM SHOWING ALL PRODUCTS. IF YOU DO NOT SEE WHAT YOU NEED, PLEASE ASK.
